

female

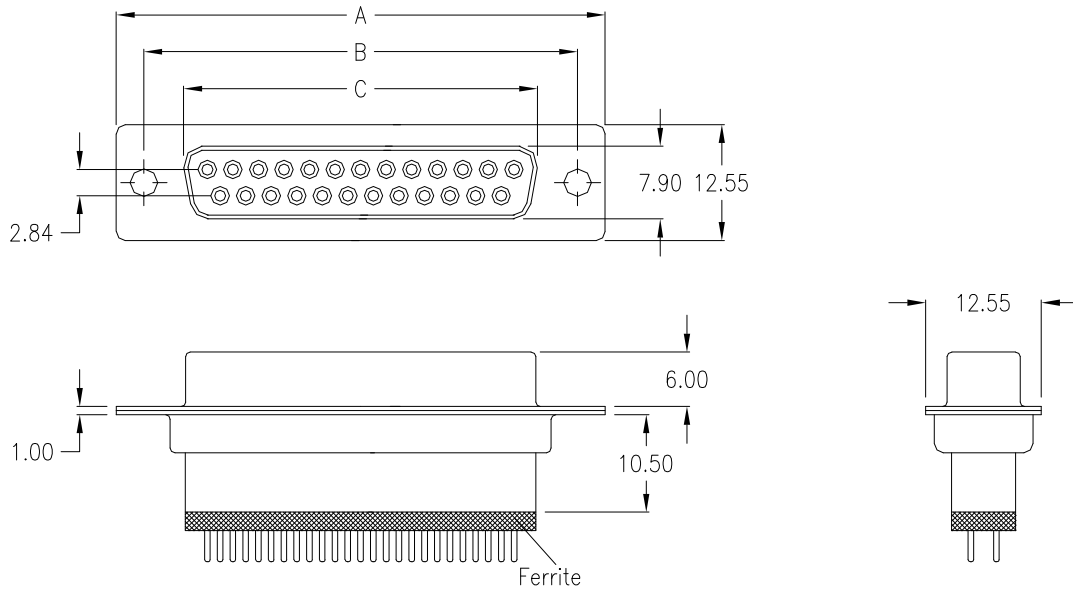

Ordering Code

**SDF - xxx - B111 - 95 / F XXX**

No. of contacts

Option

Plating: -95 = tin(leadfree)/gold

General Specification page 72

| No. of contacts | Dimension      |                |                |
|-----------------|----------------|----------------|----------------|
|                 | A              | B              | C              |
| <b>009</b>      | 30.81<br>1.213 | 24.99<br>.984  | 16.33<br>.643  |
| <b>015</b>      | 39.14<br>1.541 | 33.32<br>1.312 | 24.66<br>.971  |
| <b>025</b>      | 53.04<br>2.088 | 47.04<br>1.852 | 38.38<br>1.511 |

Options

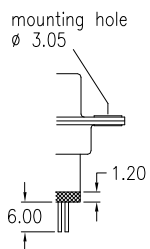

**T0**

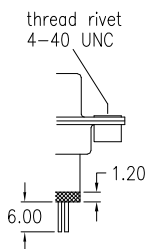

**T**

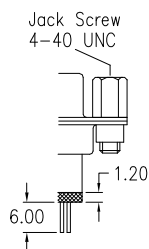

**TJ**

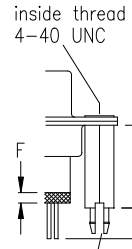

**BR**

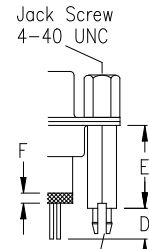

**BRJ**

| D    | E     | F    | Option   |
|------|-------|------|----------|
| 3.00 | 12,70 | 1.20 | <b>3</b> |
| 3.20 | 14,50 | 1.20 | <b>4</b> |

PCB Layout „female“

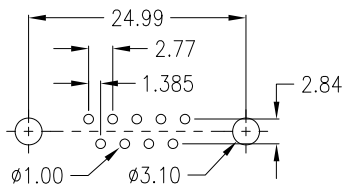

9 pin

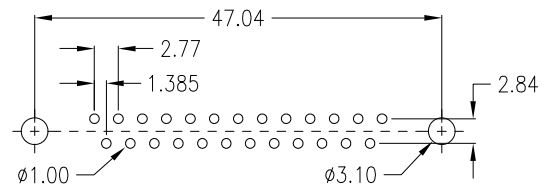

25 pin

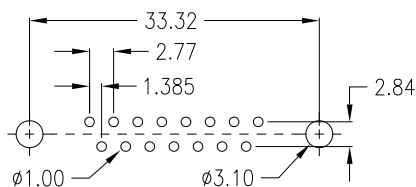

15 pin



**mechanical data**

|   |                              |
|---|------------------------------|
| Mating force per contact                                  | ≤ 3,4 N                      |
| Unmating force per contact                                | ≥ 0,2 N                      |
| Temperature range   | -55° C to +105° C            |
| Processing temperature wave solder (solder bath)          | +250°C +0/-5°C<br>for 10sec. |
| Processing temperature SMT and “pin in paste”             | +250°C +0/-5°C<br>for 10sec. |
| Moisture absorption from air 50% rh                       | 0,10%                        |
| IDC Connector types accept AWG 26 or AWG 28 standard wire |                              |

**materials and plating** (RoHS compliant)

|   |  |
|---|--|
| Insulator for wave solder technology, standard black<br>- PC 99 colourful insulator | thermoplastic glassfilled UL 94V – 0<br>Yellowish brown - Pantone # 131C 15-pos. female<br>Burgundy - Pantone # 235C 25-pos. female<br>Teal - Pantone # 322C 9-pos. male<br>Blue - Pantone # 661C HD 15-pos. |
| female  |  |
| Insulator for SMT and “Pin-In-Paste”  | Nylon UL 94V-0   |
| Shell   | Steel, Ni plated   |
| Bracket   | Brass, tin plated  |
| Male contact<br>- plating   | Copper Alloy (Standard; others on request)<br><b>-95</b> = solder side Sn; contact side Au over Ni<br><b>-55</b> = solder and contact side Au over Ni  |
| Female contact<br>- plating   | Copper Alloy (Standard; others on request)<br><b>-95</b> = solder side Sn; contact side Au over Ni<br><b>-55</b> = solder and contact side Au over Ni  |
| D-Sub Accessories (page 70) plating   | <b>-NN</b> = Ni  |

**electrical data**

|   |  |
|---|--|
| max. Current rating                     | 5 A/25°C 3 A/70°C (High Density types 3A / IDC types 1A) |
| Operating voltage                       | 250 V  |
| Test voltage between contacts           | 1000 V / 50/60 Hz / 1 Minute                             |
| Test voltage between shell and contacts | 1000 V / 50/60 Hz / 1 Minute                             |
| Resistance between mated contacts       | < 30 m Ω   |
| Insulation resistance                   | ≥ 1000 M Ω at 500V DC                                    |
| Dielectric strength                     | 1000 V AC min. for 1 Minute                              |
| Volume resistivity                      | 10 <sup>16</sup> Ω cm (ASTM-D 257 )                      |

**available performance classes**

E-tec D-Sub connectors comply with Performance Class 3 (min. 50 contact cycles).  
Please contact E-tec first for availability of Performance Class 2 (min. 200 contact cycles) and 1 (min. 500 contact cycles)

**D-Sub with Filter ( ferrite )**

|                 |                |
|-----------------|----------------|
| Frequency range | 10 - 300 MHz   |
| Impedance       | 5 MHz - 15 Ω   |
|                 | 25 MHz - 30 Ω  |
|                 | 100 MHz - 50 Ω |
|                 | 300 MHz - 75 Ω |

